

# WESTWIND SAT



# TRAIL-ET

Still Leading the Way

Designed and constructed from the same 45-year commitment to excellence of Trail-et horse trailers.

### ***Our Standards Are Not An Option!***

The Small Animal Trailer (SAT) interior is designed to keep your precious cargo safe and comfortable with standard features often options with other manufacturers ...



- padded walls, 3' high
- rubber mats on floor
- dual escape doors
- adjustable box stalls
- window bar guards
- lockable bar locks



800.344.1326 • [www.trail-et.com](http://www.trail-et.com)

# WESTWIND SAT

## STANDARD SPECIFICATIONS

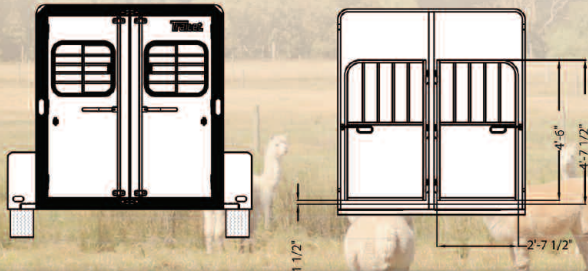
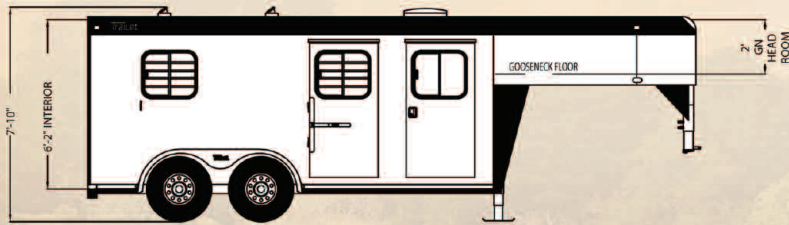
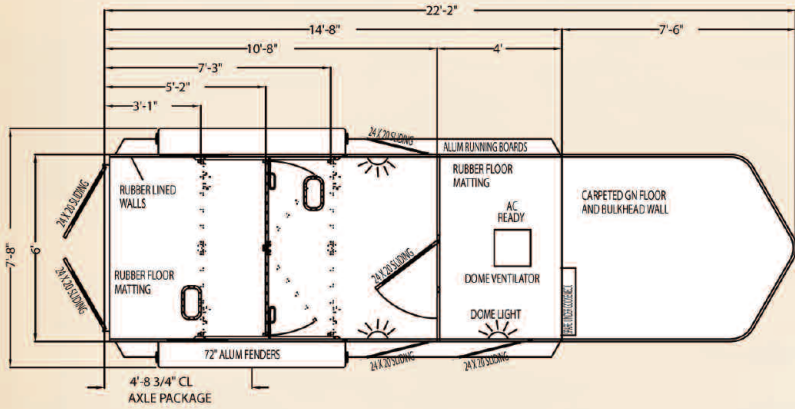

*The Westwind SAT is the ultimate in comfort and convenience ... complete with carpeted dressing area and gooseneck; and dual escape doors.*



- (2) 3,500 lbs. Torrision Braking Axles
- 5 on 4.5 Silver Mod wheels
- ST205 75R15C Tires
- 2-5/16" Coupler
- 10,000 lbs. Side Wind Jack & Safety Chains
- 12-Volt Break Away System
- LED Lights
- Aluminum Running Boards & Fenders
- Galvanized Steel Frame
- Galvanized 2"x 3" Angle Cross Members
- Galvanized Inner Skin / Aluminum Outer Skin
- All Galvanized Steel Epoxy Primed
- Trailer Interior Painted with Acrylic Urethane
- Lower Frame and Roof Line Acrylic Urethane Paint
- Fiber Glass Steel-Reinforced One-Piece Roof
- (2) Roof Vents
- (2) Full-Height Rear Doors with 20" x 20" Sliding Windows
- (2) Escape Doors with 20" x 20" Sliding Windows & Dead Bolt Latch
- 2" x 8" EnviroSAFE Wood Floor
- Box: 6' Tall x 6' Wide x 10'-6" Long, Eventor: 6' x 8'
- Box is Rubber Matted on Floor, and 3' Up on All Walls
- Box Stall Divider Adjustable 16" O.C.
- Interior Dome Light above Escape Door
- Dressing Area 4' Long x 6' Wide with Carpeted Gooseneck
- Carpeted Dress Area Bulk Head Wall & Floor
- 51" x 20" Sliding Windows on Sides of Trailer Above Fenders
- (2) 20" x 20" Sliding Windows in Front of Trailer
- Bar Guards on All Windows in Box Area
- All Doors are Equipped with Lockable Bar Locks



P.O. Box 499 - Waupaca, WI 54981  
Fax: 715.258.8593  
www.Trail-et.com

**TRAIL-ET**  
Still Leading the Way

800.344.1326